

**\*Note:** Floor plans are not to scale.  
Some room variation may exist from cabin to cabin.  
Placement of furniture, fixtures, appliances, etc. may vary from cabin to cabin.

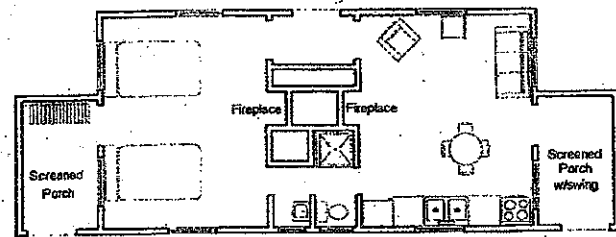

Cabin 1 & 3

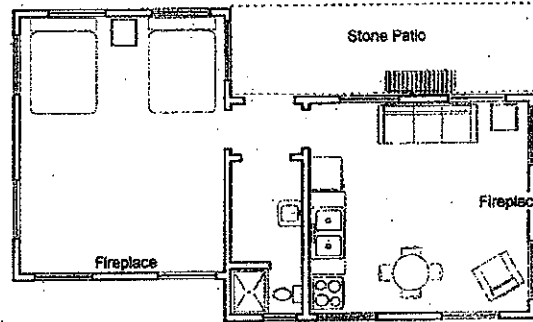

Cabin 2

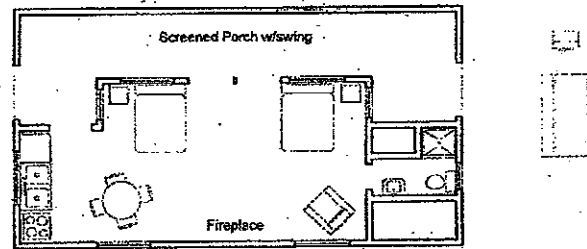

Cabin 4, 5, & 6  
Cabin 5 is Handicapped Accessible

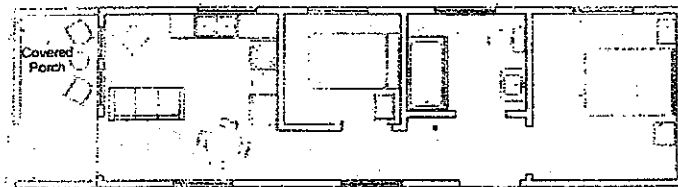

Cottage 1  
Handicapped Accessible



Tishomingo State Park  
P.O. Box 880  
Tishomingo, MS 38873



## CABINS

### Tishomingo State Park

P.O. Box 880  
(105 CR 90)  
Tishomingo, MS 38873  
662-438-6914  
Fax 662-438-6755

GPS/LAT 34° 36.700  
GPS/LON 88° 12.060

e-mail: [tishomingo@mdwfp.state.ms.us](mailto:tishomingo@mdwfp.state.ms.us)  
Website: [www.mdwfp.com](http://www.mdwfp.com)

**Cabins 1 & 3** are one bedroom cabins with two (2) double beds, wood burning fireplaces, open dining/living area and can accommodate four (4) people. There are screened porches on each end of the cabins with patio furniture; outdoor BBQ grill & picnic table.

**Cabin 2** is a one bedroom cabin with two (2) double beds, which can accommodate up to four (4) people. Open kitchen area, living room with wood burning fireplace, stone patio; outdoor BBQ grill & picnic table.

**Cabins 4, 5, 6,** are one room cabins with two double (2) beds, which accommodate four (4) people. Open kitchen area and table, wood burning fireplace, large screened porch; outdoor BBQ grill & picnic table. (No living room or sofa bed). **Cabin 5 is handicapped accessible**

**Cottage 1** is a two bedroom cottage with one queen and one double bed, open dining/living area, small covered porch with patio furniture; outdoor BBQ grill and picnic table. This small cottage can accommodate four (4) people. *Please note that this unit is not furnished with bed/bath linens.* **Cottage 1 is handicapped accessible.**

All Units are equipped with central heat/air.

**Reservations** are strongly recommended and may be made up to twenty four (24) months in advance by calling the **Park Office at 662-438-6914**; online at [www.mdwfp.com](http://www.mdwfp.com); and/or through **Reserve America at 1-800-GO PARKS (467-2757).**

Minimum length of stay during the regular season (August 16<sup>th</sup> to May 14<sup>th</sup>) is two (2) nights on weekends and no minimum during the week. Minimum length of stay during the summer season (May 15<sup>th</sup> to August 15<sup>th</sup>) is three (3) nights on weekends and no minimum during the week. Weekends are Friday and Saturday nights. A three (3) night minimum is required for holidays and special events. Maximum length of stay is 14 days.

Check-in time is 3:00 PM. Check-out time is at 11:00AM. **Please do not ask for an early check-in or later check-out time.**

#### Deposits

A deposit of 50% will be required at the time the reservation is made. **The remaining balance will be due upon arrival.** If other members of your party arrive before you and wish to pick-up the key, the balance still must be paid before the keys are released. **(Guests arriving after 5:00 pm should make arrangements with the Park Office).**

**Cancellation Policy/Fees:** A cancellation fee of \$10 will be charged on all reservations cancelled 7 days or more in advance. If cancelled 0 -6 days of

arrival **50% of the total amount for the reservation will be forfeited.** All remaining balances, if applicable, shall be placed on a voucher.

Please notify the park office if you will be arriving after 5:00pm. **All fees paid will be forfeited if a guest does not show up for their respective reservation.** The reservation will not be held after 11:00 am the morning after the scheduled arrival date. It is your responsibility to notify the park office by 11:00 am the morning following your arrival date.

**Refunds** when deemed applicable shall be subject to a transaction fee. Refunds shall be placed on a voucher and may be redeemed at any Mississippi State Park. Vouchers may have an expiration date applied per public notice. **Cash refunds are not allowed.**

#### Firewood

Firewood is available while in season. Please request in advance. The price is \$7.00 per bundle.

#### Cabin/Cottage Restrictions:

- **NO PETS ARE ALLOWED IN THE CABINS OR CABIN AREA.**
- **SWIMMING IS ALLOWED IN DESIGNATED (POOL) AREAS ONLY!**
- Cabins are designed for single family use. Parties, sleep-overs (dropping off of persons), family reunions, etc are not allowed.
- Parking is restricted to a maximum of two (2) vehicles at all times.
- **All guests and visitors are subject to entry fee requirements. No exemptions are permitted.**
- Alcoholic beverages are prohibited on state park lakes.
- The person renting the cabin must be 21 years of age and is responsible for the cabin and its contents. Children will not be left unattended overnight.
- **No camping units (tent/camper) will be allowed in the cabin area.**
- Operation of off road vehicles are not allowed on park roads or in cabin area.

#### Cabin/Cottage Furnishings

The cabin and all utensils should be left clean on departure. Furnishings should not be re-arranged in cabin or removed from cabin. Cabins are complete with: linens, pillow, blankets, bedspread, double beds, night stands, chairs, lamps, (no television or phone). *Please note Cottage 1 is not furnished with bed/bath linens.* The kitchens are furnished. See the following list.

**If any items are missing, please inform Park Staff.**

#### Kitchen Furnishings Include:

- 8 plates\*
- 8 soup bowls\*
- 8 tumblers/glasses\*
- 8 cups/mugs\*
- 8 each/knives, forks, and spoons\*
- 2 vegetable bowls
- 2 platters
- 1 pitcher
- 1 cutting board
- 1 butcher knife
- 1 serving spoon
- 1 spatula/turner
- 1 drip coffee maker
- 1 can opener
- 2 cooking pots 1.5/2.75 quart
- 1 skillet, 10"
- 1 cookie sheet
- 1 roasting pan
- 1 dish drainer

**\*Smaller units contain service for six people.**

Cabin Linens:	Large	Small	Cottage
Sheets	6	4	0
Pillow Cases	6	4	0
Bath Towels	6	4	0
Wash Cloths	6	4	0

#### Check list of things you may need:

- Personal hygiene articles
- Favorite pillow
- Clothes for the season
- Food/coffee & filters
- Alarm clock
- Games/books
- Fishing/hiking equipment

The Park Management has the authority to refuse rental, evict persons from the cabins who are disruptive and/or in violation of any polices as set forth by this or any public notice. Fines may be applied for misuse or destruction of cabins and contents. It is your responsibility to know and insure that you and/or your guest know the rules.

Any person renting or reserving a unit may be asked if he or she has a criminal background, pursuant to Miss Code Ann 45-33-49. Any person who is a registered sex offender, who rents or reserves camping /cabin facilities without informing the Park of his or her status, may be removed from the park. Any registered sex offender, who does provide the Park with notice of his or her status, may be refused access to such facilities.

**DISCLAIMER: Patrons using the facilities at any Park shall be responsible for any loss or damage caused by the patron to such facilities. The MDWFP reserves the right to pursue any legal means, whether civil and/or criminal, to recover its losses or damages.**

**Policies/rates are taken in part from the Public Notice and may be viewed in full at the park office. Other rules, regulations and fees may apply. All policies/rates are subject to change without notice given to any one person, group or organization.**

